



In This Issue

[Academic Translational Seminars RMH](#)

[Expressions of Interest: Early Career Academic Representative](#)

[Discovery Early Career Researcher Awards \(DECRA\)](#)

[Launch of The Royal Melbourne Hospital Neuroimmunology Centre](#)

[Acting Department Manager Jane Henty](#)

[ARC Future Fellowships and DECRA information session](#)

[Dept of Medicine - RMH End of Year Celebration](#)

Academic Translational Seminars RMH

The Department of Medicine RMH welcomes you to join us for the following presentation –
“Developing Leadership in innovation - Why is it important and why now” by Professor Peter Choong - Head of Department of Surgery - St Vincent's Hospital

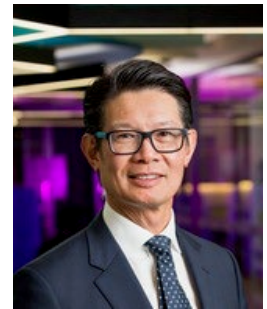

Event Details:

Date & Time: Friday, 3rd November 2023 @11:00am – 12:00pm
In-person: Venue: Ewing Theatre (5th Floor, Clinical Sciences Building, Royal Melbourne Hospital)
Virtual: Zoom [Link](#) & Password: RMHseminar

Expressions of Interest: Early Career Academic Representative

The Melbourne Medical School (MMS) is seeking expressions of interest from eligible salaried or honorary staff to join the MMS Research and Research Training (RRT) Committee in the following membership category:

- Early Career Academic (ECA) representative- one position available

Further information, including the RRT Committee membership and terms of reference can be found on the [MMS Staff Hub](#). The [MMS EMCA Info Hub](#) also contains valuable information and resources of relevance to EMCAs. The RRT committee membership is for a 12-month term, with the possibility of an extension for an additional term.

Eligibility:

- Salaried or honorary appointment in an [MMS Department](#)
- A research active academic who completed their PhD less than 5 years ago (accounting for any career interruptions)

How to apply:

Please complete an Expression of Interest via the [online form](#), and submit a brief curriculum vitae (no more than three pages) and a cover letter (no more than one page) highlighting relevant experience and interest to the MMS Research Support Team: mms-research@unimelb.edu.au by close of business **Monday 6 November 2023**. For more information regarding the role, please email Varun Venkatesh, ECA and Co-Chair Representative: varun.venkatesh@unimelb.edu.au or the MMS Research Support team: mms-research@unimelb.edu.au.

Discovery Early Career Researcher Awards (DECRA)

Overview

Discovery Early Career Researcher Awards (DECRA) supports early career researchers who have typically received their PhD in the last five years or have eligible commensurate career disruption (more information: [LINK](#))

Funding

The scheme provides funding for up to 200 projects per round. Funding is awarded by the ARC of up to \$162,897 per annum for three years, with a per annum salary contribution of \$112,897 (this includes 30 per cent on-costs), and up to \$50,000 per annum for project costs. Project costs can be used to hire research assistants, support HDR students, or fund equipment, consumables, field research, travel, and dissemination costs. See Section 5 of the Discovery Program Grant Guidelines - Fellowships (2023 Edition) for more information.

Critical Dates

12th October - Applications open in RMS
6th to 8th November 2023 - Submit review ready application to RIC
1st December 2023 - Final Application Submission due to RIC

Launch of The Royal Melbourne Hospital Neuroimmunology Centre

As of 25 September 2023, the RMH Elizabeth St is the new home of several specialist clinics including Multiple Sclerosis and Neuroimmunology. The new Neuroimmunology Centre introduces a unique concept of specialist academic-clinical centre in neuroimmunology in Australia. It brings together MS service at the Royal Melbourne Hospital and the academic research in multiple sclerosis at the Department of Medicine, University of Melbourne. The centre is a home of many DoM researchers, including the CORE unit and the largest multiple sclerosis and neuroimmunology service in Victoria, providing care for more than 1300 patients.



- The RMH Neuroimmunology Centre is inspired by large multiple sclerosis centres in Europe, Canada and US, RMH has dedicated 350 m² to this specialist centre on its new premises in Elizabeth St.
- The new model of care enables seamless integration of clinical care, with clinical trials, outcomes research and laboratory research.
- The centre integrates multidisciplinary approach to care for and research in complex neuroimmunological diseases – including neurology, rehabilitation medicine, nursing, neuropsychology, psychology, social work.
- The new Centre will have a substantially greater clinical capacity to accept referrals and manage patients with neuroimmunological conditions. The RMH Neuroimmunology Centre offers educational programs, focusing on various groups of healthcare professionals, such as neurologists, nurses and general practitioners, and also patient education in the form of a peer support program.
- The RMH Neuroimmunology Centre acts as a node for partners internally and externally – including MS Australia, MS Plus, government funding bodies, philanthropy, industry, academic collaborators, donors and sponsors of research.

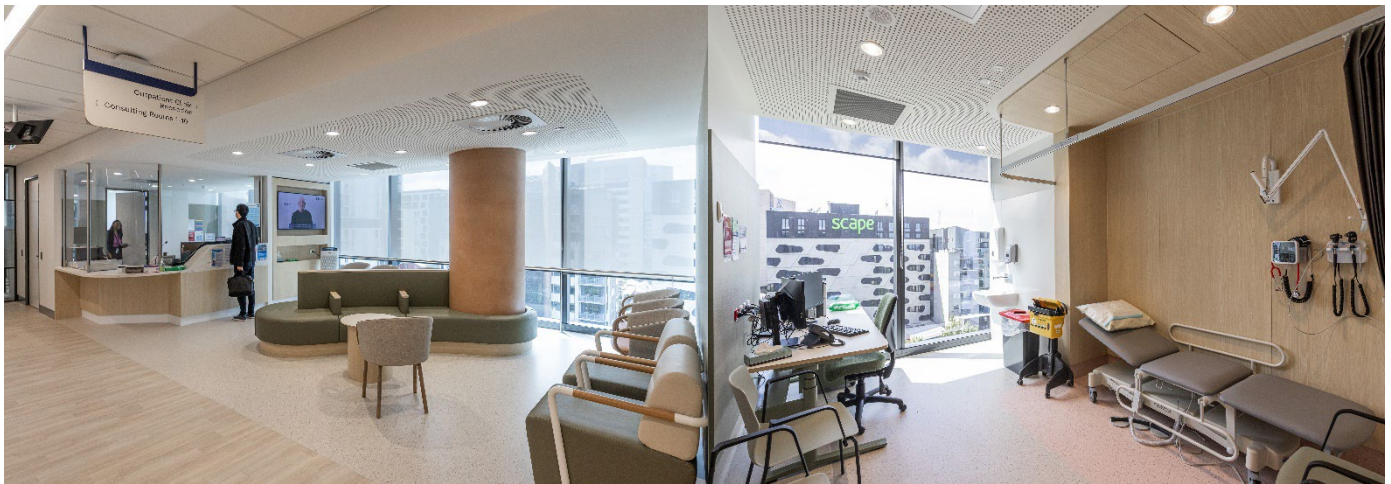

Acting Department Manager Jane Henty

Our Department Manager (Penny Mahoney) is undertaking a secondment to the Jawun Program followed by a period of leave and will return to her role on 4 January 2024.

During this time, Jane Henty will be acting as Department Manager for the Department of Medicine. Jane is the Manager Teaching and Learning in the Department of General Practice, so is very familiar with processes within our Faculty and School. Jane can be reached at jane.henty@unimelb.edu.au.

Welcome Jane.

ARC Future Fellowships and DECRA Information Session

Are you considering applying for an ARC Future Fellowship or an ARC Discovery Early Career Researcher Award (DECRA)? The RIC ARC Grants team will be hosting a one-hour session on these two ARC Discovery Fellowship schemes via Zoom. This presentation is open to all professional staff and researchers at all career stages.

The session aims to provide you with important information and changes to these schemes in the upcoming rounds: DE25 and FT24.

Further information is available:

ARC Future Fellowships: <https://sites.research.unimelb.edu.au/research-funding/arc/future-fellowships>

ARC DECRA: <https://sites.research.unimelb.edu.au/research-funding/arc/decra>

Session details: Today 12:00pm - 1:00pm via Zoom Register [here](#).

Dept of Medicine - RMH End of Year Celebration



DEPARTMENT OF MEDICINE
ROYAL MELBOURNE HOSPITAL

END OF YEAR CELEBRATION

Morning Tea

FRI 8 DEC	9:00-10:30am
	Room 432, Level 4 Clinical Sciences Building Royal Melbourne Hospital

 **by Friday 24 November 2023**

The poster features a dark blue background with white and gold fireworks and confetti. The text is primarily in white and gold, with the main title in large, bold, yellow letters. The date and time are highlighted in a white box with gold text.

Enquiries: Kaleeka Ekanayake | Department of Medicine – RMH | kaleeka.ekanayake@unimelb.edu.au
